

TKKZ

ESPRIT PLUS



ASSEMBLY
INSTRUCTIONS

TKZ ESPRIT HINGES

TKZ Esprit hinges are the ideal solution for modern offices, public buildings, and apartment and family home construction projects.

Smooth 3D adjustability enables precision alignment of the door in the frame for a flawless seal that prevents heat loss. The high-quality TKZ ESPRIT hinge is subjected to 200,000 test cycles without any maintenance intervention. Key characteristics include silent operation and proven reliability in intensive use scenarios.

The elegant design and selection of finishes make it easy to choose hinges that match the style of any interior.



FINISHES



Satin nickel



Satin bronze

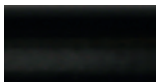

Matt black RAL 9005

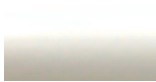

Matt white RAL 9016

Can be produced in other RAL colors.

- concealed hinge
- 3D adjustability
- universal left/right installation
- 186° opening angle
- stainless-steel pins on ball bearings

COVER PLATES

The hinges are supplied with matching snap-on cover plates for installation after final adjustment have been made.

TECHNICAL SPECIFICATIONS

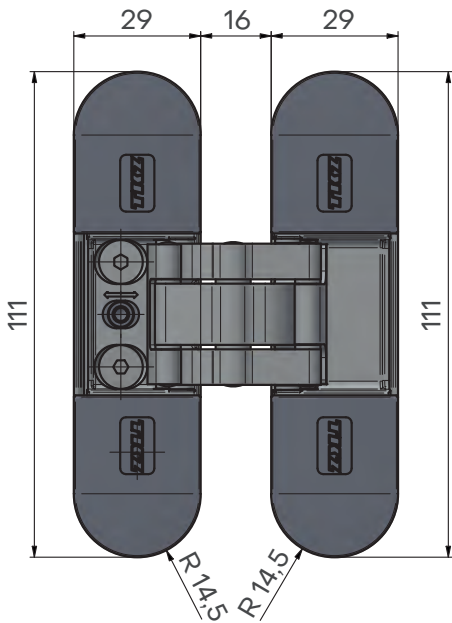

Vertical adjustment
± 2 mm

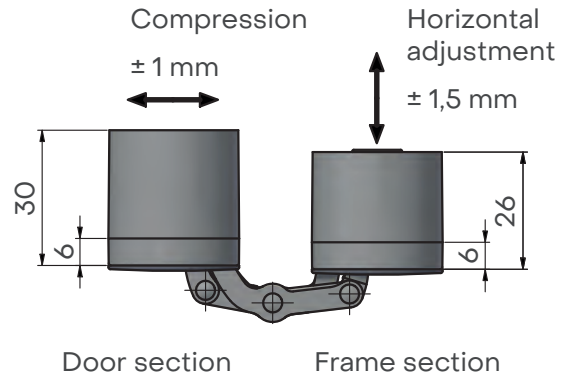

Door section

Frame section

LOAD CAPACITY

Hinge load capacity for
2000 x 800 mm door.

1 hinge - certified 30 kg

		DOOR WIDTH (mm)			
		600	800	900	1000
DOOR WEIGHT (kg)	80	>3	>3	N	N
	75	3	>3	>3	N
	70	3	3	>3	>3
	65	3	3	3	3
	60	2	3	3	3
	55	2	2	3	3
	50	2	2	2	3
	45	2	2	2	2
	40	2	2	2	2

N = NOT RECOMMENDED

HINGE CERTIFICATION

The hinge load capacity is tested and certified in compliance with ETA 18 / 0877 class 10. The hinge is certified to EI 30 / EW 30 fire resistance and has an RC2 security rating. Validity of the RC2 and EI 30 / EW 30 certification is contingent on the use of suitable security devices designed to prevent the door from being taken off its hinges.

HINGE POSITIONING

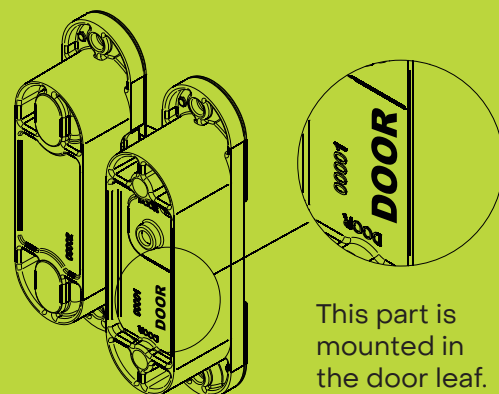

This part is mounted in the door leaf.

INSTALLATION PER DIN STANDARDS

DIN 18 101

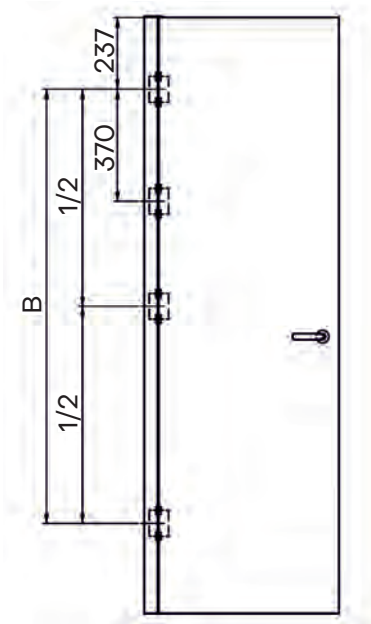

Door height (mm)	B (mm)
1860 - 2110	1435
2111 - 2235	1560
2236 - 2360	1685

INSTALLATION VIDEO



MORTISES FOR INSTALLATION

FRAME MORTISE

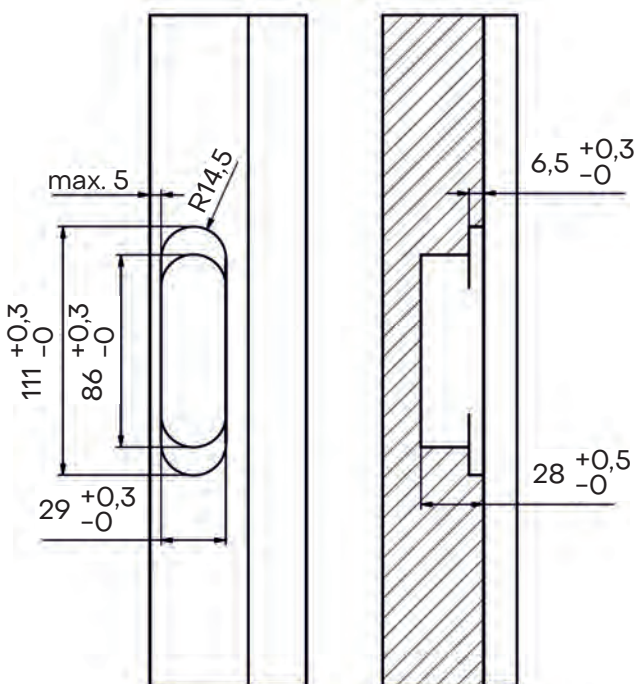

DOOR MORTISE

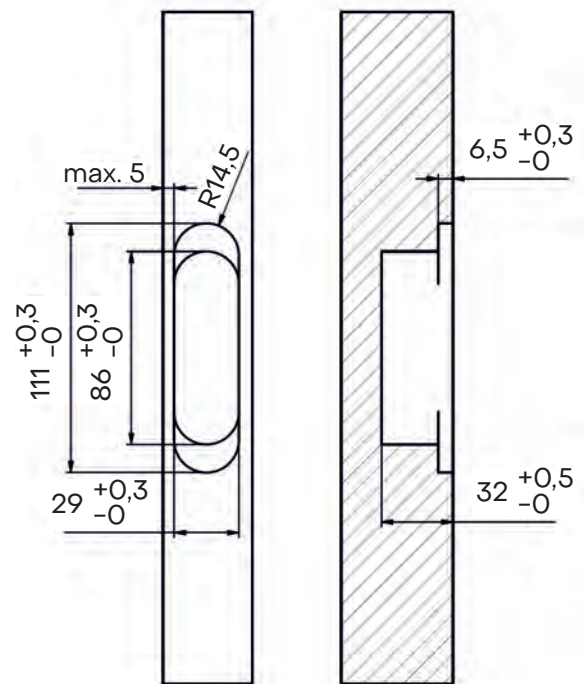

KINEMATICS

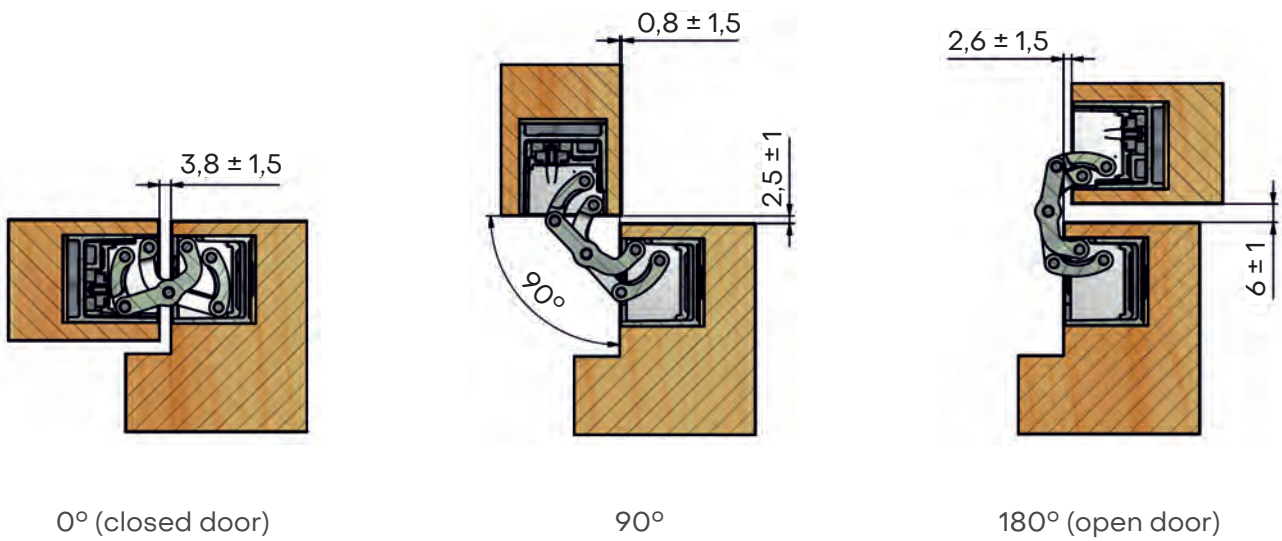

RECEIVER FOR METAL DOORFRAME

9835 0530 RECEIVER TKZ ESPRIT OZ ZN

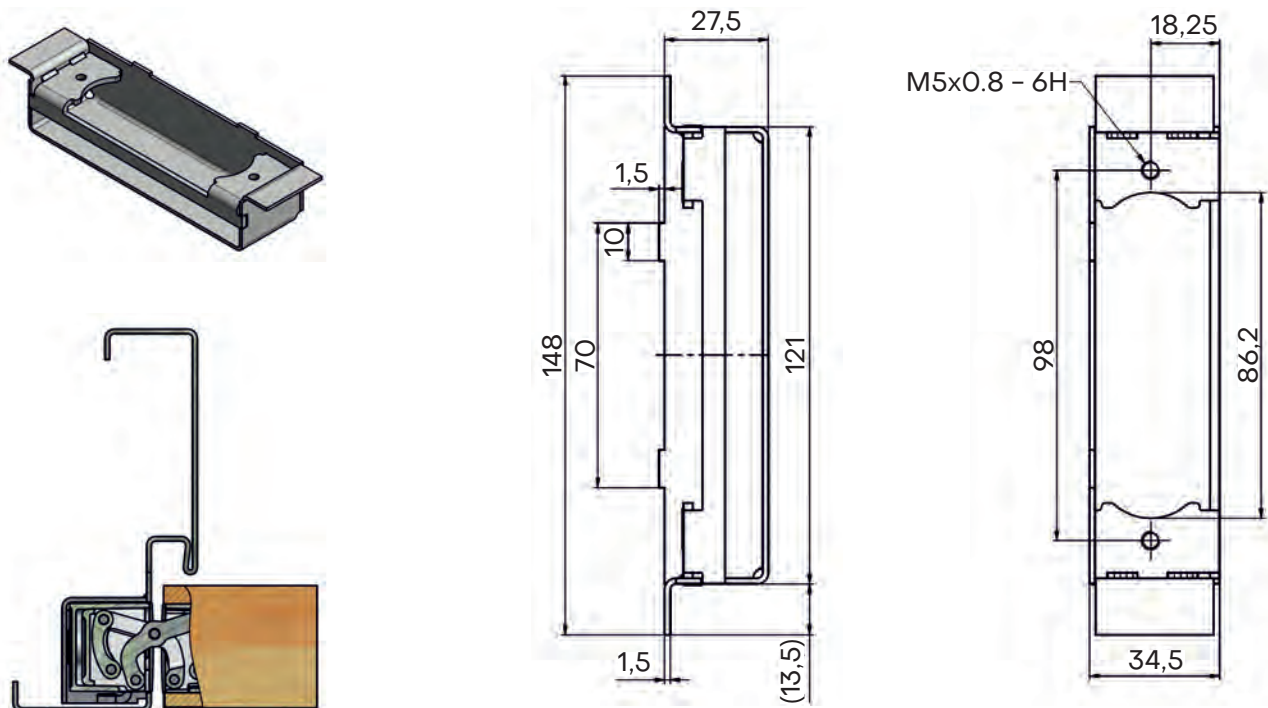

TKZ ESPRIT ANCHOR PLATE

		C
9837 0530	galvanized anchor plate	0 mm
9844 0530	galvanized anchor plate	2 mm
9838 0530	galvanized anchor plate	4 mm
9836 0530	galvanized anchor plate	6 mm
9839 0530	galvanized anchor plate	9 mm

$$A - 6,5 = C$$

A = casing thickness at hinge mounting point.
Mounting plate depth (C) can be adjusted by using the supplied spacers.

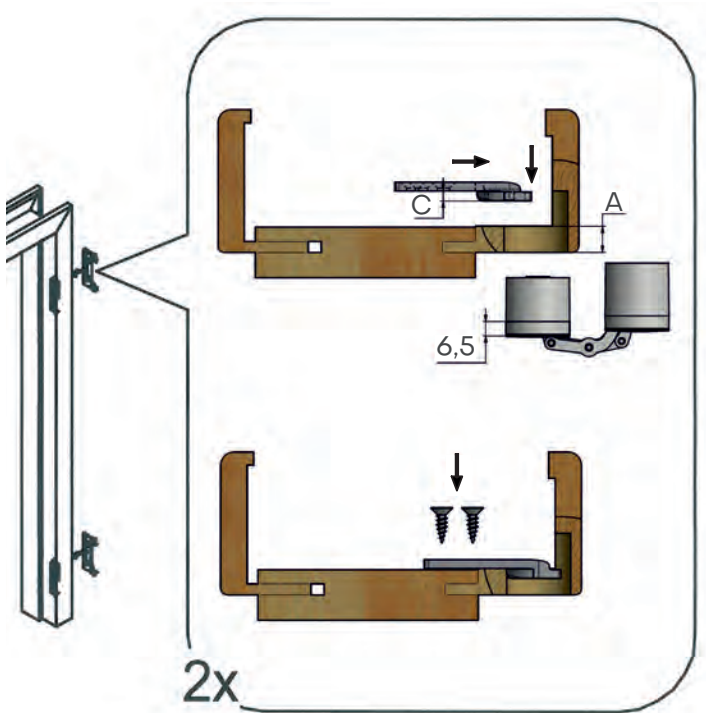
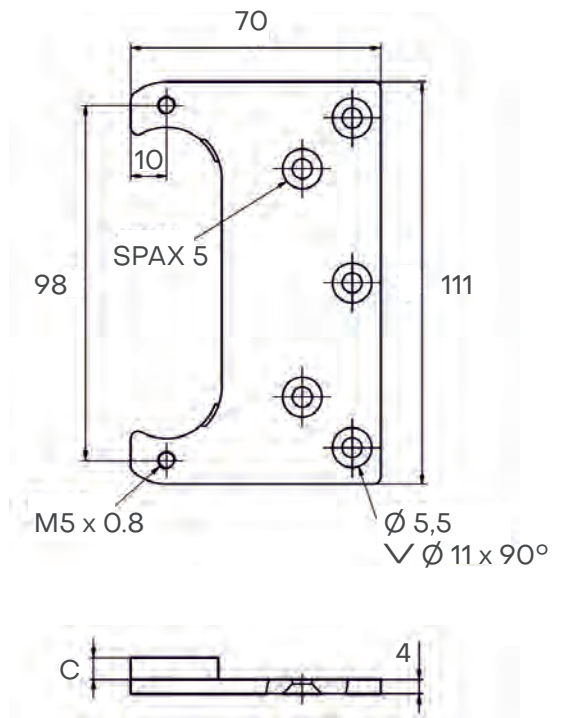

Set includes

1x	anchor plate
2x	spacers 1 mm
2x	spacers 0,5 mm

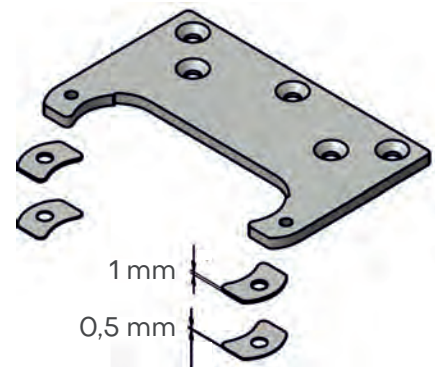

TKZ ESPRIT PLUS Z ADJUSTMENT

All adjustments must be made with a 3 mm hex key (after installation of the hinges on the door and frame).

VERTICAL ADJUSTMENT

Loosen the adjusting screws by at least one full turn. ①

With the wedges in place, manually raise or lower the door by ± 2 mm.

RETIGHTEN THE ADJUSTING SCREWS! ①

RECOMMENDATION: Insert wedges beneath the door for easier handling.

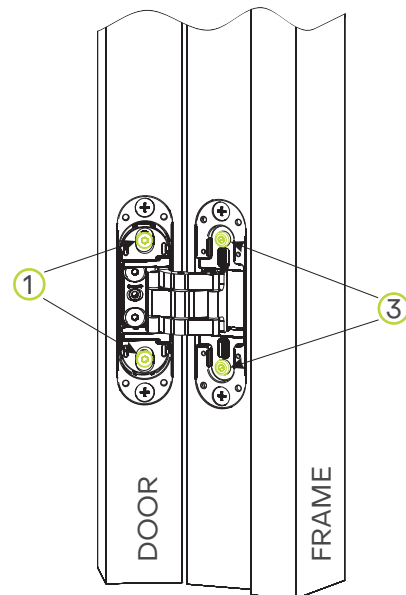

HORIZONTAL ADJUSTMENT

Gently adjust the door by ± 1.5 . ③

Turn both screws to adjust the position of the door.

RECOMMENDATION: When making adjustments, do not extend the door away from the frame beyond the maximum range. Doing so may prevent correct installation of the cover plates.

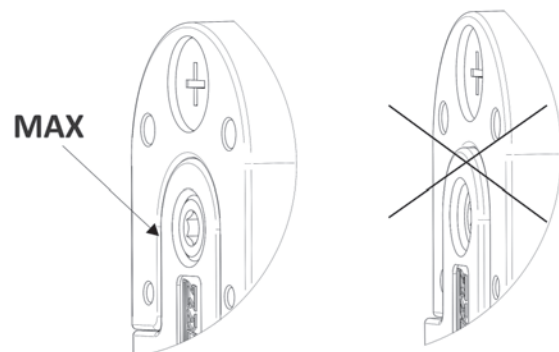

COMPRESSION ADJUSTMENT

Loosen the adjusting screws. ④

Manually adjust the door by ± 1 mm. ⑤

RETIGHTEN THE ADJUSTING SCREWS! ④

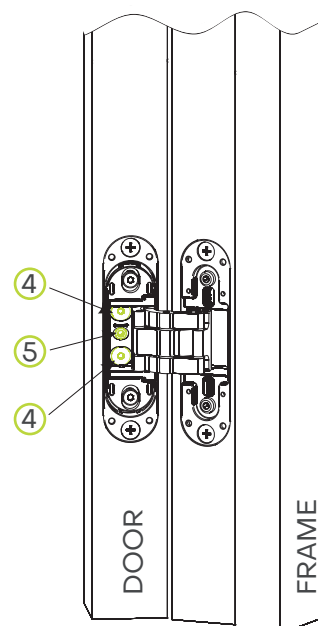

INSTALLING HINGE IN DOOR LEAF

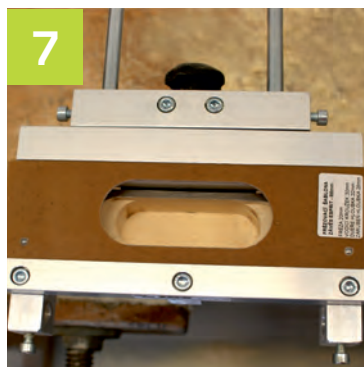
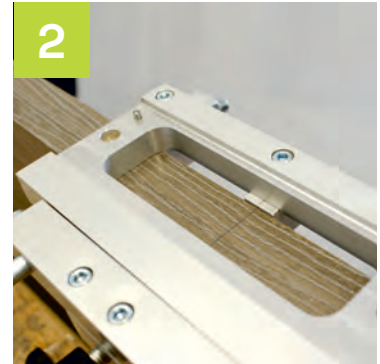

INSTALLING HINGE IN DOORFRAME

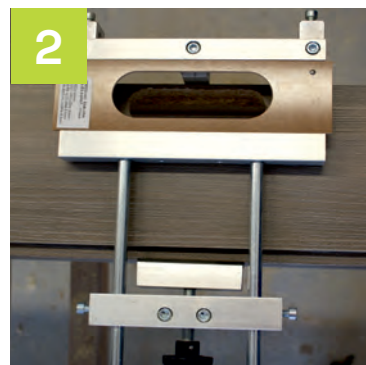
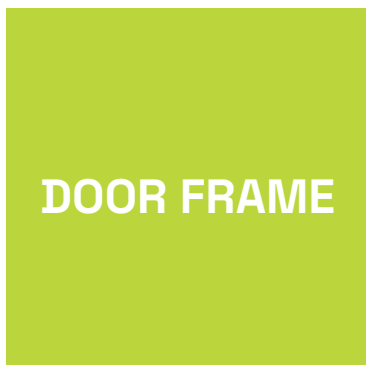

TKZ ESPRIT INSTALLATION TOOLS

Guides supplied with template as standard.

1. JIG

- cut the door mortise to a depth of 32 mm
- cut the frame mortise to a depth of 28 mm
- bit \varnothing 20 mm
- template guide \varnothing 30 mm



2. JIG

- cut the door mortise to a depth of 6.5 mm
- cut the frame mortise to a depth of 6.5 mm
- bit \varnothing 20 mm
- template guide \varnothing 30 mm

For milling use

Template guide



\varnothing 30 mm

Straight router bit

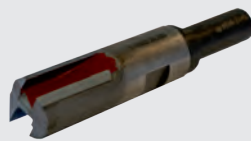

\varnothing 20 mm
délka 110 mm

Jig

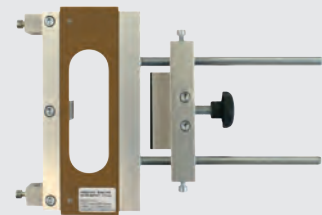

with 2 alternative guides





THE HISTORY OF TKZ begins in 1911. Its genetic code is top-notch metalwork. Gradually, we have become a significant European company in the production of window and door hinges and have built an excellent global reputation in the field of replicas of historical hinges.

1911

Company founded, production of metal goods, 50 employees, manufacturing space of 1,000 m².

1955

Commencement of production of construction and furniture fittings.

1976

New pressing plant, machining shop, and tool room - expansion of production space to 4,000 m².

1981

Fully automated welding machine line.

1998

Start of production of adjustable hinges TRIO and EXPERT, commissioning of own testing facility.

2010

Expansion of production space to a total area of 8,000 m².

2015

Start of production of hidden hinge ESPRIT for groove-less doors.

2017

Expansion of warehouse space by 2,000 m².

2022

Doubling of production capacity for hidden hinges.

2024

New welding facility of 2,000 m².

PRESENT TKZ's scope of products and solutions encompasses a wide range of custom metal manufacturing in addition to hinges. This includes not only small items, but also metal conveyor belts spanning hundreds of meters, as well as complex conveyor systems and intricate metal structures.

TKZ Polná, spol. s r. o.

A leading Czech manufacturer of building and furniture hardware with more than 100 years of tradition.

TKZ Polná, spol. s r. o.
Zahradní 572, 588 13 Polná, CZ
+420 567 155 211
www.tkz.cz

Published 9/2024
All rights reserved

