

A healthcare worker in green scrubs and a hairnet is writing on a curved wooden counter in a hospital hallway. The hallway is brightly lit with recessed ceiling lights. In the background, there are white doors and a red heart-shaped decoration hanging from the ceiling. The overall scene is clean and professional.

CORIAN®  
FOR HEALTHCARE.

**DU PONT**

*The miracles of science™*

MEDICAL PLAZA  
MEDICAL OFFICES

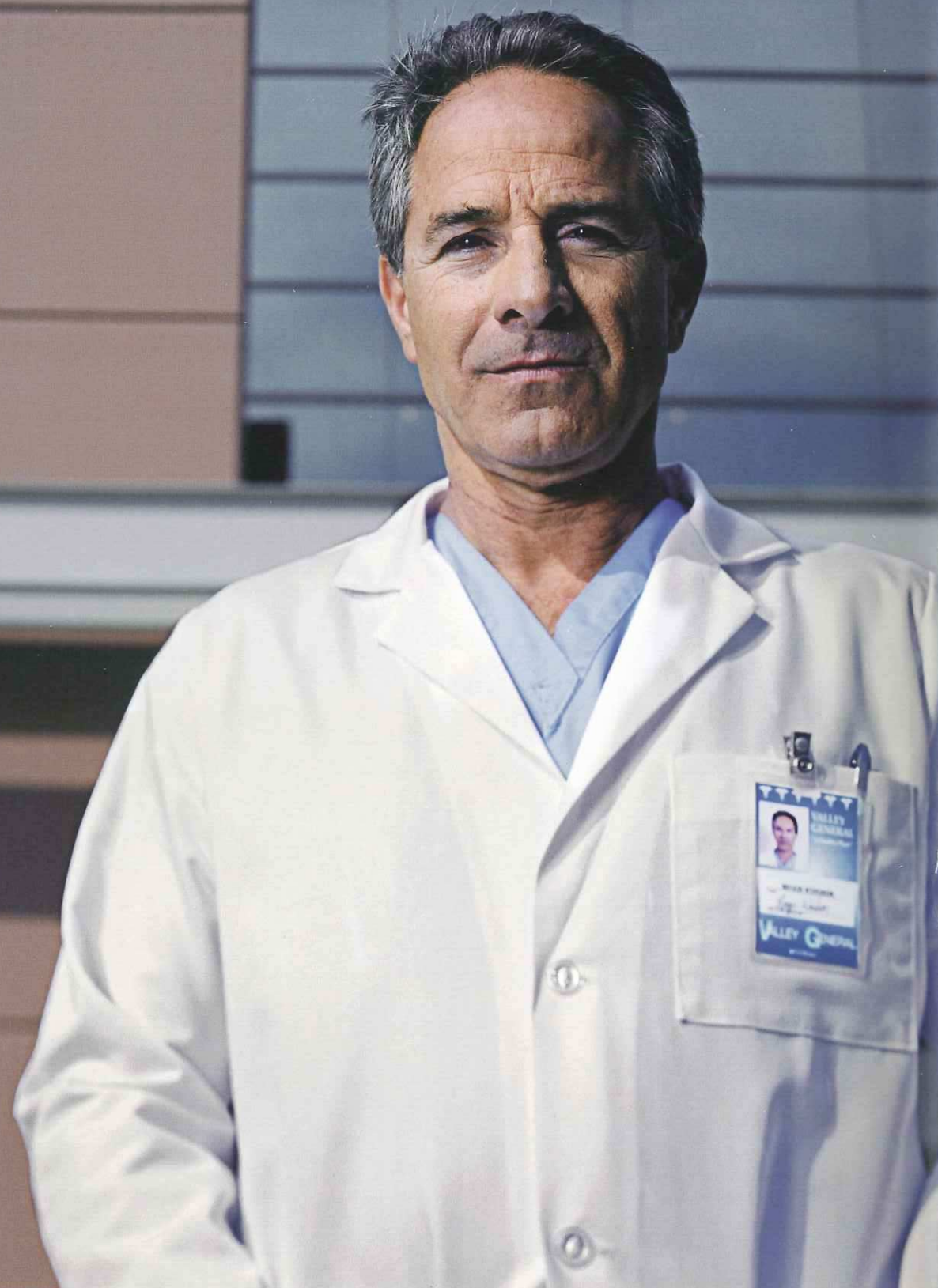

## FROM RECEPTION TO THE ER AND EVERYWHERE IN BETWEEN.

Every year over two million patients will contract a nosocomial infection during a hospital stay. But **CLEAN**, sanitary surfaces can help. Corian® is a **NONPOROUS**, solid surface that when kept clean doesn't support the growth of bacteria, mold or mildew. It makes virtually **SEAMLESS** construction possible. So DuPont™ Corian® Solid Surfaces make spaces easy to clean and sanitize. It's also a **PREFERRED** surface according to proposed 2006 AIA healthcare facility design guidelines, and it's **APPROVED** for use in cafeterias, operating rooms, nurses' stations, patient rooms and even elevators. What's more, it's **DURABLE**, delivering long-term value in a tough environment. Since there's no off-gassing, Corian® supports good indoor air quality. And Corian® is the **BEAUTIFUL** solid surface that's thermoformable and available in over 110 colors. Which makes it easier for you to design **WARM** and **INVITING** interiors without sacrificing performance.



**CLEANLINESS  
—AN ALLY IN THE FIGHT  
AGAINST INFECTION**



Infections are responsible for almost 50% of post-surgery complications. Recent studies show that bacteria can be transferred from surfaces like sinks or countertops to the hands of patients and staff alike, making it easier to spread infection throughout a healthcare facility. Keeping surfaces clean and sanitary can help prevent this problem.

Corian® is a nonporous, solid surface that when cleaned regularly and effectively does not support the growth of bacteria, mold and mildew. Unlike natural stone, it eliminates costly, repeated sealing. And with Corian® there is no risk that delamination will expose a porous surface which can promote the growth of microorganisms.

*With Corian® you can undermount sinks and integrate backsplashes — virtually eliminating caulks or seams that may support microbial growth.*

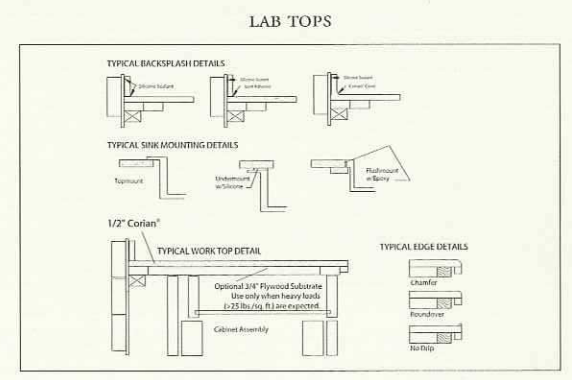



DURABLE.



HIGH-VALUE.

**A COST-EFFECTIVE  
SOLUTION  
TO LONG-TERM  
SURFACE CARE**



Facility managers know there are few environments as tough on surfaces as healthcare. High traffic, gurneys, carts, and even medical equipment take a heavy toll on surfaces from corridors to ERs to kitchens. And constant repainting and repairing are not only costly, they can cause ongoing disruptions in hospital operations.

Corian® helps save time and money on maintenance and repair. It's chip- and scratch-resistant to stand up to years of heavy use. In fact, two miles of Corian® installed in kitchen areas, the operating room, elevators and corridors have saved Bozeman Deaconess Hospital \$30,000 to \$50,000 annually on wall repair and painting costs.

*Easily fabricated and durable, Corian® is a lasting, appealing material for wainscoting, handrails and cornerguards.*

WAINSCOTING AND BUMPER RAIL

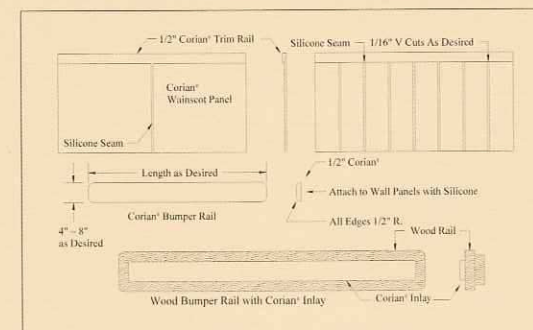



APPROVED.

MEETING THE  
HIGHEST STANDARDS,  
INCLUDING YOURS



In a highly regulated healthcare environment, code compliance is always top-of-mind. Corian® is NSF/ANSI 51 Certified for food contact with all food types. It's Class 1(A) fire-rated. Corian® is also easily molded or formed to eliminate sharp edges, making it ideal for ADA-approved handrails.



PREFERRED.

Corian® already meets the proposed 2006 American Institute of Architects (AIA) healthcare facility design guidelines for preferred surfaces. Corian® has been tested to ensure it's easy to install and nontoxic, and does not support the growth of bacteria, mold and mildew when properly cleaned. A list of Corian® performance properties is included at the end of this brochure.

*From cafeterias to kitchen cart wash areas, Corian® meets all applicable food and fire codes.*

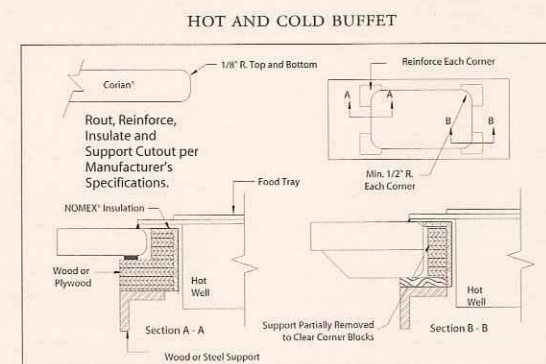



BEAUTIFUL.

CLEAN DESIGN  
WITH MUCH  
MORE THAN  
SURFACE APPEAL

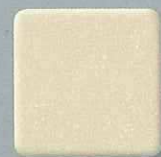

White to naturally inspired Sage. But Corian® offers more than the widest color choice available.

Today's architects and designers know that healing facilities should be both aesthetically pleasing and functional. Corian® meets these needs with a palette of over 110 colors, from the clean brilliance of Glacier



RENEWABLE.

It's also thermoformable, so it can work within the limitations of existing spaces and yet mold to the curved and organic shapes that inspire your imagination. And Corian® is renewable — ordinary abrasives easily remove nicks and scratches — so your designs look like new year after year.

*A thermoformable surface, Corian® conforms to your designs from work stations to wainscoting.*

WORK STATION

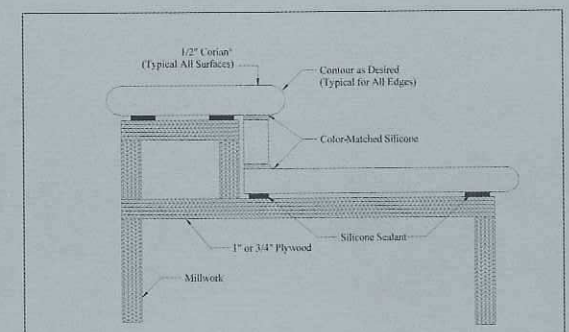



WARM.

CREATING SPACES  
PATIENTS AND STAFF  
CAN FEEL GOOD ABOUT



When you care about healthcare, patients matter most. Corian® lets you create a warm, friendly environment that makes them more comfortable, helping create a positive impression about the quality of care. And Corian® makes it easier to sustain better air quality — there's virtually no off-gassing, or VOCs, and it's nontoxic.



INVITING.

What's more, specifying Corian® in a variety of applications can help your construction project earn points towards the voluntary LEED™ (Leadership in Energy and Environmental Design) Green Building Rating System developed by the U.S. Green Building Council for high-performance, sustainable buildings.

*Even in often-overlooked areas, Corian® is aesthetically pleasing and easy to install.*

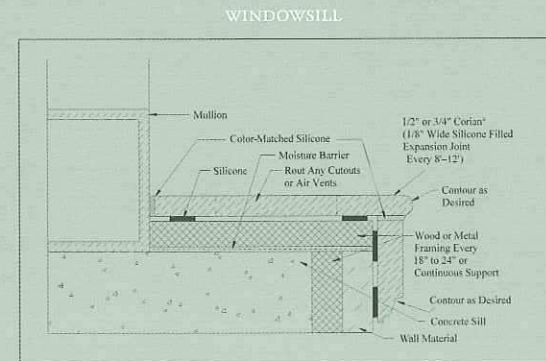



BEFORE.



AFTER.

**BRINGING LIFE  
TO NEW AND EXISTING  
FACILITIES**

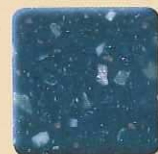

Today, Corian® is a leading choice in surface materials of facility managers, designers and architects. In fact, Corian® is specified in almost 50% of all healthcare projects across the country according to the McGraw Hill Construction Database. And Corian® is chosen both for its aesthetic and functional appeal.

Perfect for both new construction and renovations, Corian® is easily installed or retrofitted over existing sound tiles or other surfaces. And with an extensive national network of professional fabricators and installers, you're assured of high availability, customized options, and a surface that meets your needs for years to come.

*Undermounted sinks and covered backsplashes virtually eliminate seams and make it easier to clean vanity top areas.*

SEAMLESS UNDERMOUNTED SINK

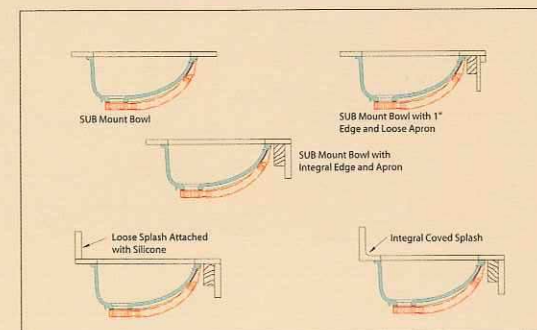



## WHERE TO USE CORIAN® SOLID SURFACES

Labs, patient rooms, operating rooms, nurses' stations, cafeterias, and reception areas are just a few of the many places where Corian® works. Wherever you use it, Corian® provides a durable, renewable, nonporous solution that makes your healthcare facility easier to clean and helps you lower maintenance costs.

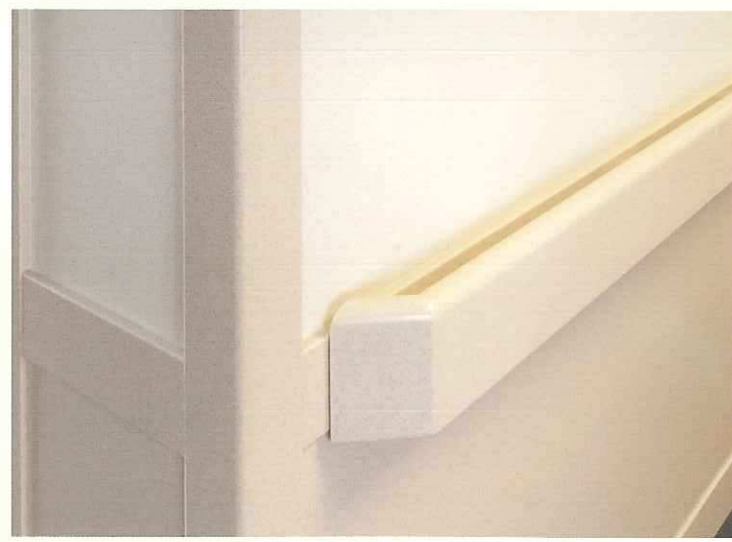

**HANDRAIL AND CORNERGUARD** Easily fabricated and durable, Corian® is the perfect material for ADA approved handrails.



**CONDIMENT COUNTER** Ideal for all food service and disposal areas, Corian® is NSF/ANSI 51 Certified for food contact.



**FOOD SERVICE TRAY SLIDES** Not only is Corian® solid and stain-resistant, minor scratches can be removed with ordinary abrasives.

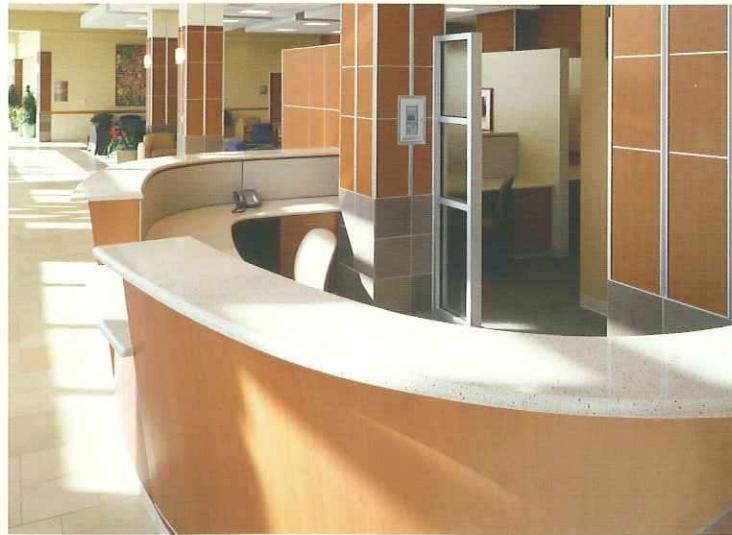

**PATIENT ADMISSIONS** Suitable for admission, reception and office areas, Corian® makes a strong statement about the quality of care.



**EXTERIOR CLADDING** An excellent choice for exterior applications, Corian® resists stains, environmental pollutants, humidity and freeze-thaw conditions.

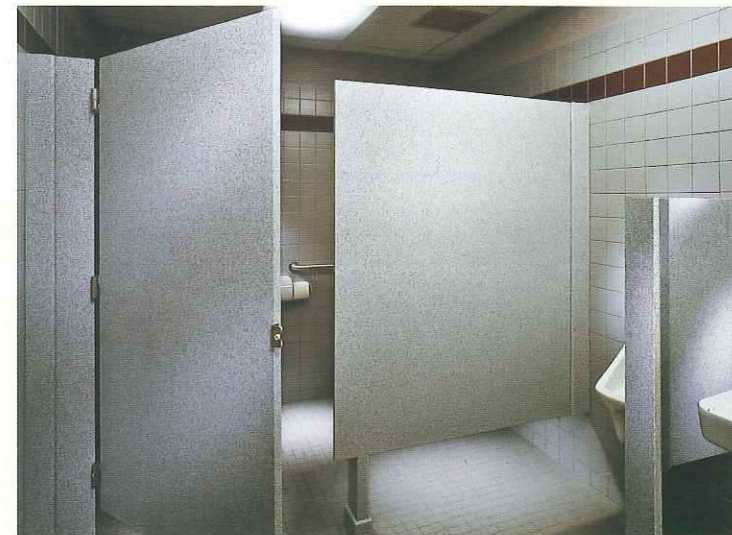

**TOILET PARTITIONS** Available in over 110 colors, Corian® makes it simple to color-coordinate walls, partitions, sinks and vanities.



**ELEVATOR CLADDING** Chip- and scratch-resistant, Corian® is the solution to high-traffic maintenance problems.



**TRASH RECEPTACLES** Since Corian® Solid Surfaces are durable and impact-resistant, they provide excellent protection to walls and trash receptacles.



**NURSERY BATH** Unlike stainless steel, Corian® is a warm material that never looks clinical or cold, making it ideal for nursery sinks and baths.



**CART WASH AREA** In harsh environments that must withstand steam and 180 degree temperatures, Corian® can eliminate constant repainting and repair expenses.



**LAB COUNTER** Laboratory test results demonstrate that Corian® can be easily cleaned with a diluted bleach solution.



OUTPATIENT SURGERY ROOM CLADDING *Chip-resistant Corian® is durable enough to stand up to hard knocks from gurneys, chairs and medical equipment.*



WALL CAP *Scratch-resistant and solid, Corian® is child-friendly and easy to keep clean in pediatric spaces.*



TRANSACTION COUNTER *Durable and solid, Corian® stands up in heavy traffic areas to help minimize repair and maintenance costs.*



SINK WITH INTEGRAL TOP *Easy to fabricate, Corian® opens up novel design options even for spaces that must be kept clean and sanitary.*



WINDOWSILL *Many Corian® colors provide exceptional weathability to eliminate repainting expenses.*



PATIENT ROOM SINK *Patient rooms need to be simple to maintain yet promote patient healing. Corian® helps create appealing spaces that look newer longer.*



FORENSIC TABLE *Nonporous, renewable and stain-resistant, Corian® surfaces work throughout hospital facilities.*



STORAGE AREA *Corian® is strong and durable enough for use in many storage areas including maintenance closets.*



NURSES' STATION *Malleable and warm, Corian® helps designers and architects create ergonomic and staff-friendly areas.*



WAINSCOTING TO WINDOWSILL *Thermoformable and available in over 110 colors, Corian® provides virtually unlimited trim and finish options.*



HOT AND COLD BUFFET *From cafeterias to cafés, Corian® withstands heat or cold in all food preparation or serving areas.*



SPLASH-FREE SINK *Moldable yet nonporous, Corian® can help you control the spread of disease when properly cleaned.*

# COMPARISON OF CORIAN® AND OTHER SURFACE MATERIALS

(Data noted in this table represents typical values for the product category)

ATTRIBUTE	PHYSICAL PROPERTY	CORIAN® ACRYLIC SOLID SURFACE	ACRYLIC/POLYESTER BLEND	POLYESTER	HIGH PRESSURE LAMINATE <sup>(1)</sup>	ENGINEERED STONE	GRANITE
FLAMMABILITY	Flammability Class Rating <sup>(2)</sup>	Class I (Class A)	Class I (Class A)	Not classifiable if SDI >450	Class I (Class A)	Class I (Class A)	Class I (Class A) <sup>(3)</sup>
	Flame Spread Index (ASTM E84/UL 723)	<25	<20	15	15	<5	0
	Smoke Development Index SDI (ASTM E84/UL 723)	<25	<235	>500	<250	<75	0
TEMPERATURE RESISTANCE	High Temperature Resistance (NEMA LD-3)	No effect	Varies (No effect to has an effect)	Varies (No effect to has an effect)	Not recommended in areas where temperature >275°F	None to slight effect	None
STRENGTH AND DURABILITY	Tensile Strength (ASTM D638)	6,200 psi	5,000 psi	4,300 psi	varies	–	1,500 psi <sup>(4)</sup>
	Flexural Strength (ASTM D790)	10,500 psi	8,729 psi	8,294 psi	varies	7,838 psi	1,200 psi <sup>(5)</sup>
	Flexural Modulus (ASTM D790)	1.4 x 10 <sup>6</sup> psi	1.3x10 <sup>6</sup> psi	1.2x10 <sup>6</sup> psi	varies	5.1x10 <sup>6</sup> psi	N/A
	Potential for delamination, chips or cracks	No	No	No	Yes	No	Yes
MAINTENANCE	Stain resistance	Very Good	Very Good	Very Good	Fair	Good	Variable, Very Good to Poor
	Renewable	Yes	Yes	Yes	No	No <sup>(6)</sup>	No
	Resistant to common chemicals	Very Good	Very Good	Very Good	Fair	Good	Poor
HELPS REDUCE INFECTIONS	Nonporous	Yes	Yes	Yes	No	Yes	No
	Inconspicuous Seams	Yes	Yes	Yes	No	Yes	No
	Integrated Sinks (one molded piece or inconspicuous seam w/ smooth finish)	Yes	Yes	Yes	No	No <sup>(7)</sup>	No
	Thermoformable	Yes	No	No	No	No	No
	Does not support microbial growth	Yes	Yes	Yes	No	Yes	No
	Food Contact (NSF/ANSI 51 Certified) <sup>(8)</sup>	Yes	Yes	Yes	No <sup>(9)</sup>	Yes	No

## HOW CORIAN® MEASURES UP

Not only does Corian® stand up to the demanding healthcare environment, but it also outperforms other surfacing materials. Corian® can deliver a combination of characteristics that make it the preferred surface for a broad range of applications. Thanks to its thermoformability and selection of over 110 colors, Corian® offers unsurpassed design flexibility for today's and tomorrow's designs.

Products in each category are solid colors, which generally have a gauge of approximately 0.5 inches, a filler loading >55% ATH and are not translucent in appearance.

<sup>(1)</sup> This category refers to High Pressure Laminate, which is fire-resistant and unbonded.

<sup>(2)</sup> Flammability ratings are brand specific. Individual product formulation impacts flammability.

<sup>(3)</sup> Non-combustible; inorganic material, thus no smoke, no flame; products represented in this table include granite only.

<sup>(4)</sup> Flexural Strength, Minimum ASTM C880.

<sup>(5)</sup> Modulus of Rupture, Minimum ASTM C99.

<sup>(6)</sup> Engineered Stone does not require renewability. Stains can typically be removed using standard cleaning techniques without damage to the original factory finish.

<sup>(7)</sup> Acrylic or polyester molded sinks may be undermounted with a smooth finish to Engineered Stone countertops; however, this fabrication technique may not be recommended or warranted by the manufacturer(s).

<sup>(8)</sup> NSF Certification is brand specific. While many solid surface manufacturers of acrylic, polyester, blends and engineered stone have obtained NSF/ANSI 51 Food Contact certification for their products, others have not.

<sup>(9)</sup> High Pressure Laminate has NSF/ANSI Std. 35 certification, which is designated for laminated plastic sheets (high-pressure) for limited use as work, splash, and nonfood contact surfaces of food-service equipment.

# CORIAN® PERFORMANCE PROPERTIES

PROPERTY	TYPICAL RESULT	TEST
Tensile Strength	6,000 psi	ASTM D 638
Tensile Modulus	1.5 x 10 <sup>6</sup> psi	ASTM D 638
Tensile Elongation	0.4% min.	ASTM D 638
Flexural Strength	10,000 psi	ASTM D 790
Flexural Modulus	1.2 x 10 <sup>6</sup> psi	ASTM D 790
Hardness	>85	Rockwell "M" Scale
	56	ASTM D 785 Barcol Impressor ASTM D 2583
Thermal Expansion	3.02 x 10 <sup>-5</sup> in./in./°C (1.80 x 10 <sup>-5</sup> in./in./°F)	ASTM D 696
Gloss (60°Gardner)	5-75 (matte—highly polished)	ANSI Z124
Light Resistance (Xenon Arc)	No effect	NEMA LD 3-2000 Method 3.3
Wear and Cleanability	Passes	ANSI Z124.3 & Z124.6
Stain Resistance: Sheets	Passes	ANSI Z124.3 & Z124.6
Fungus and Bacteria Resistance	Does not support microbial growth	ASTM G 21 & G 22
Boiling Water Resistance	No visible change	NEMA LD 3-2000 Method 3.5
High-Temperature Resistance	No change	NEMA LD 3-2000 Method 3.6
Izod Impact (Notched Specimen)	0.28 ft.-lbs./in. of notch	ASTM D 256 (Method A)
Ball Impact Resistance: Sheets	No fracture—1/2 lb. ball: 1/4" slab—36" drop 1/2" † slab—144" drop	NEMA LD 3-2000 Method 3.8
Weatherability	ΔE* <sub>94</sub> < 5 in 1,000 hrs.	ASTM G 155
Specific Gravity †	1.7	
Water Absorption	Long-term 0.4% (3/4") 0.6% (1/2" †) 0.8% (1/4")	ASTM D 570
Toxicity	99 (solid colors) 66 (patterned colors)	Pittsburgh Protocol Test ("LC50" Test)
Flammability	All colors (Class I and Class A)	ASTM E 84, NFPA 255 & UL 723
Flame Spread Index	<25	
Smoke Developed Index	<25	

## WHY USE CORIAN®

When you choose DuPont™ Corian® Solid Surfaces, you get much more than a proven history of performance. You get a solid surface that has undergone the rigorous testing that only DuPont can provide. So you're assured of a surface that meets or exceeds your expectations.

† Approximate weight per square foot 1/4" (6 mm) 2.2 lbs. • 1/2" (12.3 mm) 4.4 lbs.  
Shapes meet or exceed the ANSI Z124.3 and ANSI Z124.6 standards for plastic sinks and lavatories.  
NEMA results based on the NEMA LD 3-2000

## DUPONT — A RECOGNIZED LEADER IN THE FIGHT AGAINST DISEASE AND INFECTION.

For years, healthcare professionals have used DuPont products to help protect themselves and their patients from disease and infection. Every day and around the world, DuPont advanced medical fabrics, medical packaging, antiseptics, and protective garments are at work helping to improve patient care and staff safety.



*DuPont™ Suprel™ and Sofiessa® medical fabric for OR gowns, drapes and isolation apparel*



*DuPont™ Tychem® chemical protective garments for ER first responders*



*DuPont™ Tyvek® protective material for use in sterile medical packaging*



*DuPont™ Tyvek® for cleanroom apparel and accessories*



*DuPont™ Sontara® micro-level cleaning wipes for cleanroom processes*



*DuPont™ RelyOn™ antiseptic and disinfectant sprays, wipes, powders and tablets*