

Installation instructions for Rear Set Triumph Street Triple 765 with reverse shifting, year 2017 - Part nr. 5470



We would like to thank you for purchasing PP Tuning rear sets. Please take a moment to read the assembly instructions. Following these instructions will ensure trouble free operation of this product and extend its working life.

Left side installation

Remove the original rear set and follow instructions according to pictures 1. and 2. Remove the nut M10 and set the nut PP M10x30, which is a part of the package – picture 3. Install the shift lever to this nut according to picture 4.

If you have original OEM Quickshifter on your motorcycle, you have to change pulling one for the pushing one. Without this change the reverse shifting will not work. If you have motorcycle without Quickshifter it will work properly.

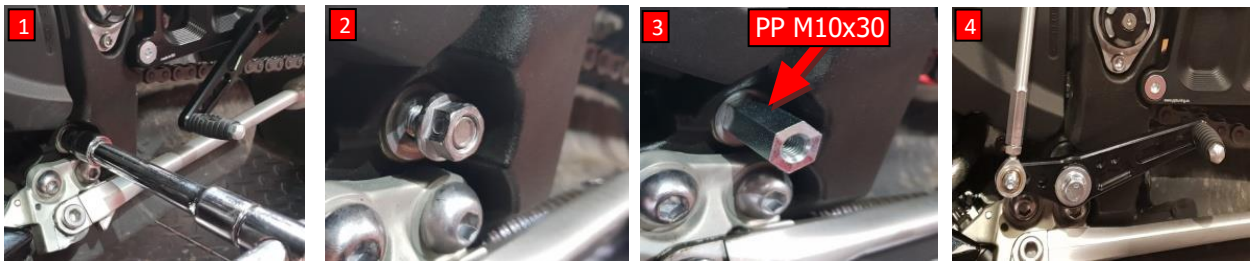

Right side installation

Pictures No. 5 - 7 show the correct way to install the right side. Use the rubber, which is a part of the package of OEM rear set to exhaust support (marked with red arrow in picture 6). Insert a washer \varnothing 31,6 x 10mm (part of the package) between the exhaust and the holder (marked with red arrow in picture 7).



And the last important information: Enjoy this product and drive carefully!

PP Tuning Team